

The Kenneth J. Minnaert Center for the Arts

Gallery Floor Plan Information

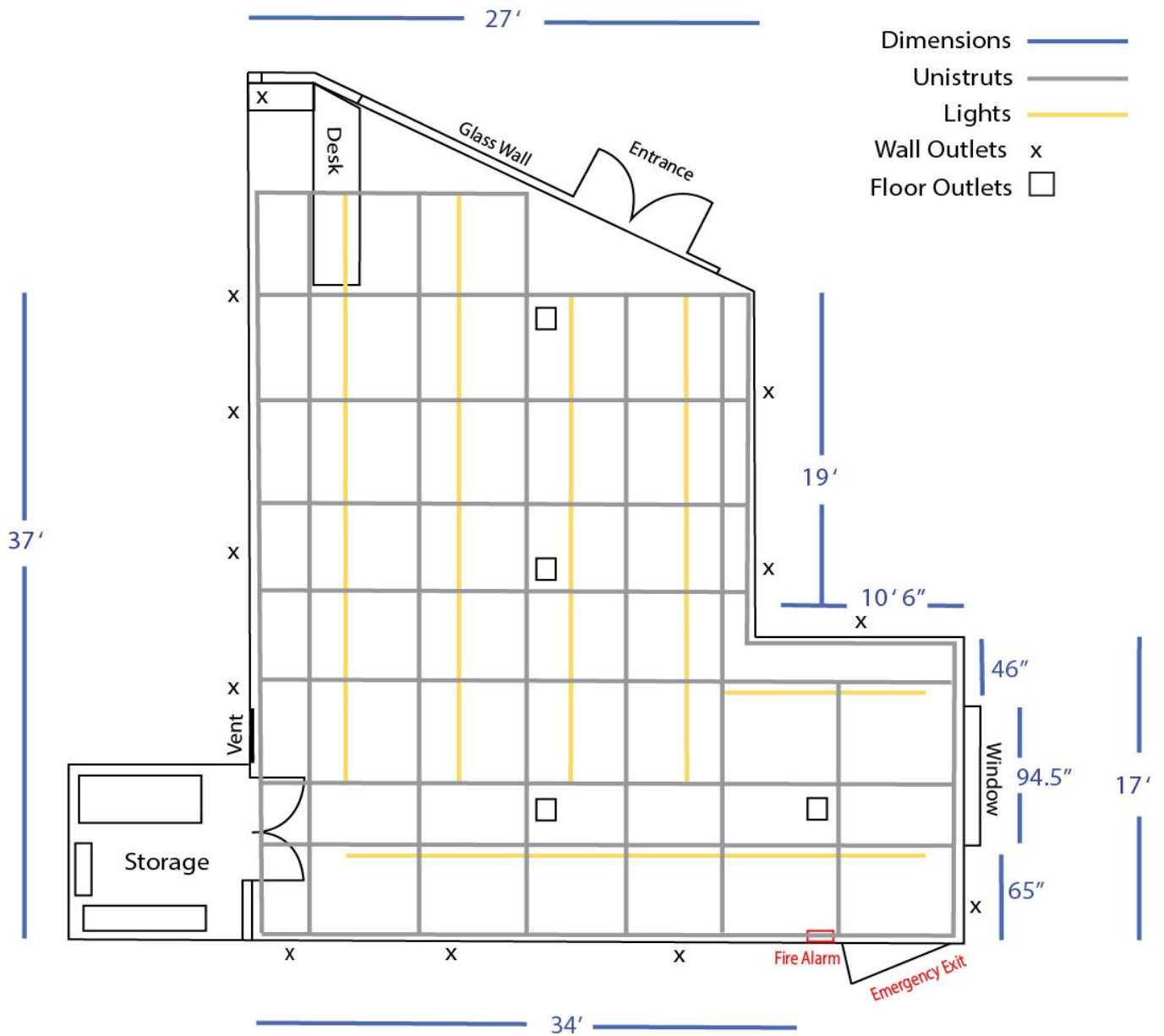

ABOUT THE GALLERY: The Gallery is 1200 square feet. There is a Unistrut® grid system (with heavy-duty movable eyebolts) at a height of 11' 6" above the floor with a track lighting system throughout: 50 watt, 570 lumen LEDs, cool white light 400K.

The walls are textured white drywall with 3/4" plywood backing. There are four 4' x 6' movable hanging walls and the floor is black granite tile. There are 15 white pedestals of varying sizes: height/length/width

- 3@ 10" x 2' x 2'
- 3@ 3' x 18" x 18"
- 3@ 3' 6" x 16" x 16"
- 3@ 3' x 14" x 14"
- 3@ 3' 6" x 1' x 1'