

The Kenneth J. Minnaert Center for the Arts

Gallery Floor Plan Information

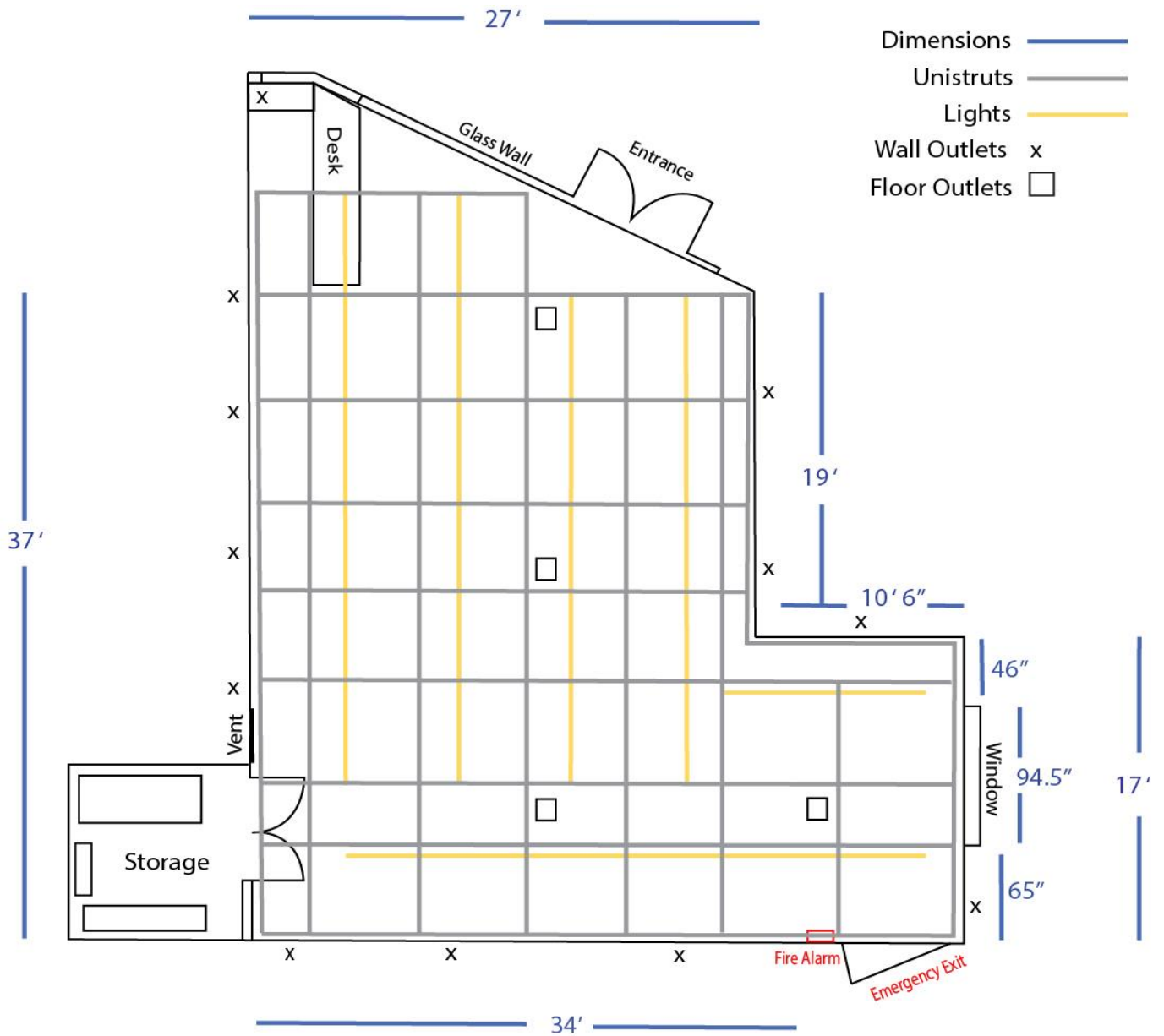

There is a Unistrut[®] grid system (with heavy-duty movable eyebolts) at a height of 11' 6" above the floor.

The walls are textured white drywall with $\frac{3}{4}$ " plywood backing. The floor is black granite tile.

Track lighting system: 50 watt, 570 lumen LEDs, cool white light 400K.

There are 15 white pedestals of varying sizes: height/length/width

3@ 10" x 2' x 2'

3@ 3' x 18" x 18"

3@ 3' 6" x 16" x 16"

3@ 3' x 14" x 14"

3@ 3' 6" x 1' x 1'